

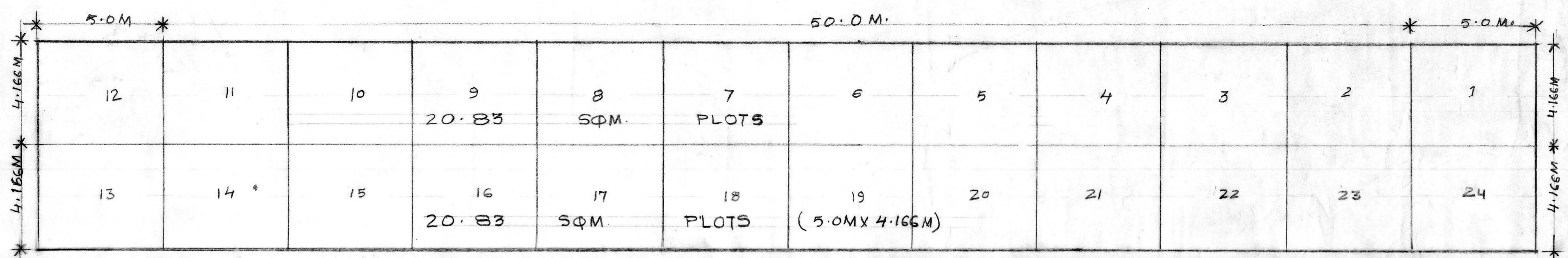

PLOTS 12.5 SQM.

ROAD 9.0 M W I D E



ROAD 4.0 M W I D E

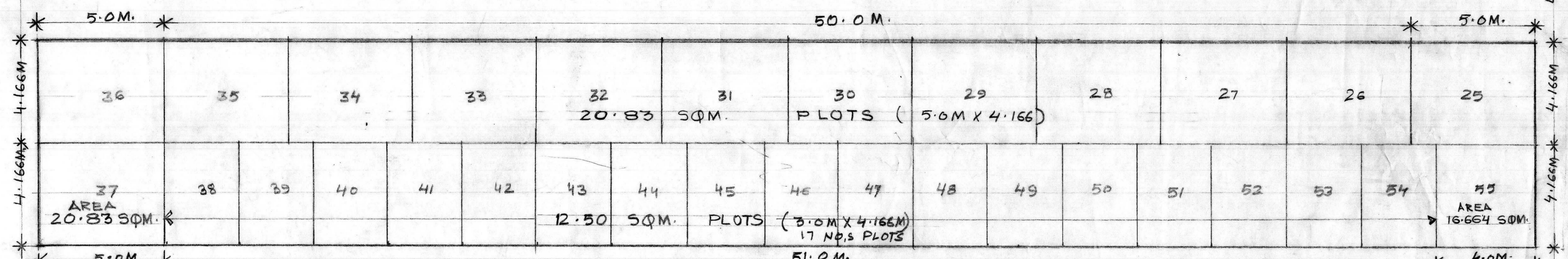

ROAD 4.0 M W I D E

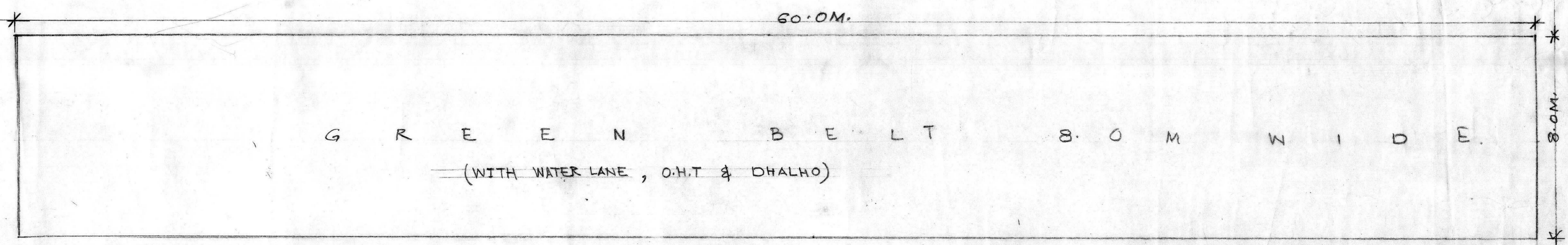

ROAD 6.0 M W I D E

MULT. FACILITIES

**PLOTS STATEMENT :-**

- 1 PLOTS NOS 1 TO 37 (3.0M X 4.166) 20.83 SQM
- 2 PLOTS NOS 38 TO 54 (3.0M X 4.166) 12.50 SQM
- 3 PLOT NO. 55 SIZE (4.0M X 4.166M) 16.664 SQM

THE SCHEME WAS DISCUSSED IN THE 266th SCREENING COMMITTEE MEETING HELD ON 25/07/08 VIDE N: 107/2008 THE PROPOSAL AS REFLECTED IN THE AGENDA HAS BEEN APPROVED

DELHI DEVELOPMENT AUTHORITY  
HUPW-COORDINATION UNIT  
V E R I F I E D

THIS PROPOSAL WAS CONSIDERED IN THE 266th SCREENING COMMITTEE MEETING HELD ON 25/07/08 VIDE ITEM NO 107/2008

Sd/-  
DY. DIRECTOR (ARCH) / CORD.

DELHI DEVELOPMENT AUTHORITY  
C E R T I F I E D

APPROVED IN 266th SCREENING COMMITTEE  
DT 25/07/08 VIDE ITEM NO 107/2008

SIGN. - Sd/-  
NAME: A.K. DASS  
DIRECTOR NARELA PROJECT

CARVING OUT 37 NOS PLOTS FOR BA WEA KAROL BAGH WITH REF TO HON. BLE HIGH COURT MATTER (KULDEEP PRAJ VS) DDA BY AMALGAMATING THE PLOTS IN SECTOR 8 PKT-II NARELA SUB-CITY

Scale माप 1cm = 1M.	Date दिनांक 25.02.2008	North N
Dealt by नियंत्रण PLG. ASST	Asstt dir सहायक निरीक्षक	Drawing no ड्राइंग नं.
Jt. Dir. उप निरीक्षक	DIRECTOR	